

Just Listed

# 1024 ELLINGTON DOWNS WAY

ELLINGTON DOWNS WESLEY CHAPEL, NC 28110



Offered at

**\$395,900**

5 Beds 4 Total Baths

2,745 SqFt MLS# CAR3593849

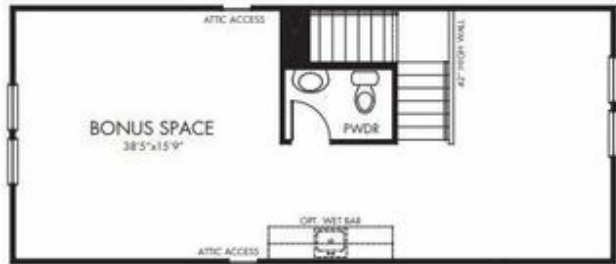

Brand NEW energy-efficient home ready May-June 2020! Same floor plan as our model home. The Granville's welcoming foyer leads into the open-concept living area and kitchen. This well-equipped

ranch features a versatile flex space, private owner's suite and secondary bedrooms joined by a Jack-and-Jill bath. Ellington Downs private community amenities will include a resort-style swimming pool with cabana and playground. Known for our energy-efficient features, our homes help you live a healthier and quieter lifestyle while saving thousands of dollars on utility bills.



HELEN ADAMS REALTY

Home  
Buying  
Process

HELEN ADAMS REALTY

704. 944. 9237

[web@helenadamsrealty.com](mailto:web@helenadamsrealty.com)

This listing flyer is intended to provide general information to prospective purchasers of the property based upon reliable public and private sources of real estate data. It is not intended as a substitute for a thorough investigation by the buyer of all facts material to buyer's decision to purchase. Although all information provided is believed accurate as of the date of first publication shown below, a buyer should never rely solely upon promotional materials without independent verification prior to submission of an offer to purchase. Items such as price, availability, and school assignments may change at any time, and Helen Adams Realty expressly disclaims any responsibility for decisions in reliance upon any information contained herein that has become out-of-date. The flyer may not be reproduced or distributed without the express written permission of Helen Adams Realty, which reserves all rights as to any material which is proprietary or otherwise subject to copyright. DATE OF FIRST PUBLICATION: 05/26/20